

NEPA COMPLIANCE CHECKLIST

State: _____ Federal Financial Assistance Grant/Amendment: _____

Grant/Project Name: _____

This proposal is; is not completely covered by categorical exclusion(s) _____ in 516 DM 8.5 (Service); and/or _____ in 43 CFR 46.210 (DOI).

(check (✓) one)(Review proposed activities. An appropriate categorical exclusion must be identified before completing the remainder of the Checklist. If one or more categorical exclusions do not apply to the entire proposal, or the proposal cannot meet the qualifying criteria in the categorical exclusion(s), or an extraordinary circumstance applies (see below), an EA may be required. E.g. an existing EA may address the proposal.)

Extraordinary Circumstances (43 CFR 46.215):

Will This Proposal (check (✓) yes or no for each item below):

- Yes No a. Have significant impacts on public health or safety.
b. Have significant impacts on such natural resources and unique geographic characteristics as historic or cultural resources; park, recreation or refuge lands; wilderness areas; wild or scenic rivers; national natural landmarks; sole or principal drinking water aquifers; prime farmlands; wetlands (Executive Order 11990); floodplains (Executive Order 11988); national monuments; migratory birds; and other ecologically significant or critical areas.
c. Have highly controversial environmental effects or involve unresolved conflicts concerning alternative uses of available resources [NEPA Section 102(2)(E)].
d. Have highly uncertain and potentially significant environmental effects or involve unique or unknown environmental risks.
e. Establish a precedent for future action or represent a decision in principle about future actions with potentially significant environmental effects.
f. Have a direct relationship to other actions with individually insignificant but cumulatively significant environmental effects.
g. Have significant impacts on properties listed, or eligible for listing, on the National Register of Historic Places as determined by the bureau.
h. Have significant impacts on species listed, or proposed to be listed, on the List of Endangered or Threatened Species, or have significant impacts on designated Critical Habitat for these species.
i. Violate a Federal law, or a State, local, or tribal law or requirement imposed for the protection of the environment.
j. Have a disproportionately high and adverse effect on low income or minority populations (Executive Order 12898).
k. Limit access to and ceremonial use of Indian sacred sites on Federal lands by Indian religious practitioners or significantly adversely affect the physical integrity of such sacred sites (Executive Order 13007).
l. Contribute to the introduction, continued existence, or spread of noxious weeds or non-native invasive species known to occur in the area or actions that may promote the introduction, growth, or expansion of the range of such species (Federal Noxious Weed Control Act and Executive Order 13112).

(If any of the above extraordinary circumstances receive a "Yes" check (✓), an EA may be required. Consult with WSFR grant specialist for determination.)

Yes No This grant/project includes additional supporting information.

Concurrences/Approvals:

Project Leader: _____ Date: _____

State Authority Concurrence: _____ Date: _____

(with financial assistance signature authority, if applicable)

Within the spirit and intent of the Council of Environmental Quality's regulations for implementing the National Environmental Policy Act (NEPA) and other statutes, orders, and policies that protect fish and wildlife resources, I have established the following administrative record and have determined that the grant/amendment:

- is a categorical exclusion as provided by 516 DM 8.5 (Service) and/or 43 CFR 46.210 (DOI), and/or is addressed by an existing EA or EIS. No further NEPA documentation will therefore be made.
 is not completely covered by the categorical exclusion as provided by 516 DM 8.5 (Service) and/or 43 CFR 46.210 (DOI), or addressed by an existing EA or EIS. An EA must be prepared.
 is covered by an existing EA. FONSI/EAS dated: _____

Service signature approval:

Staff Specialist, WSFR:

Chief, Division of WSFR:

ATTACHMENT 1
USGS TOPOGRAPHIC
SITE LOCATION MAP

PLOTTED: 7/8/2015 3:01:02 PM

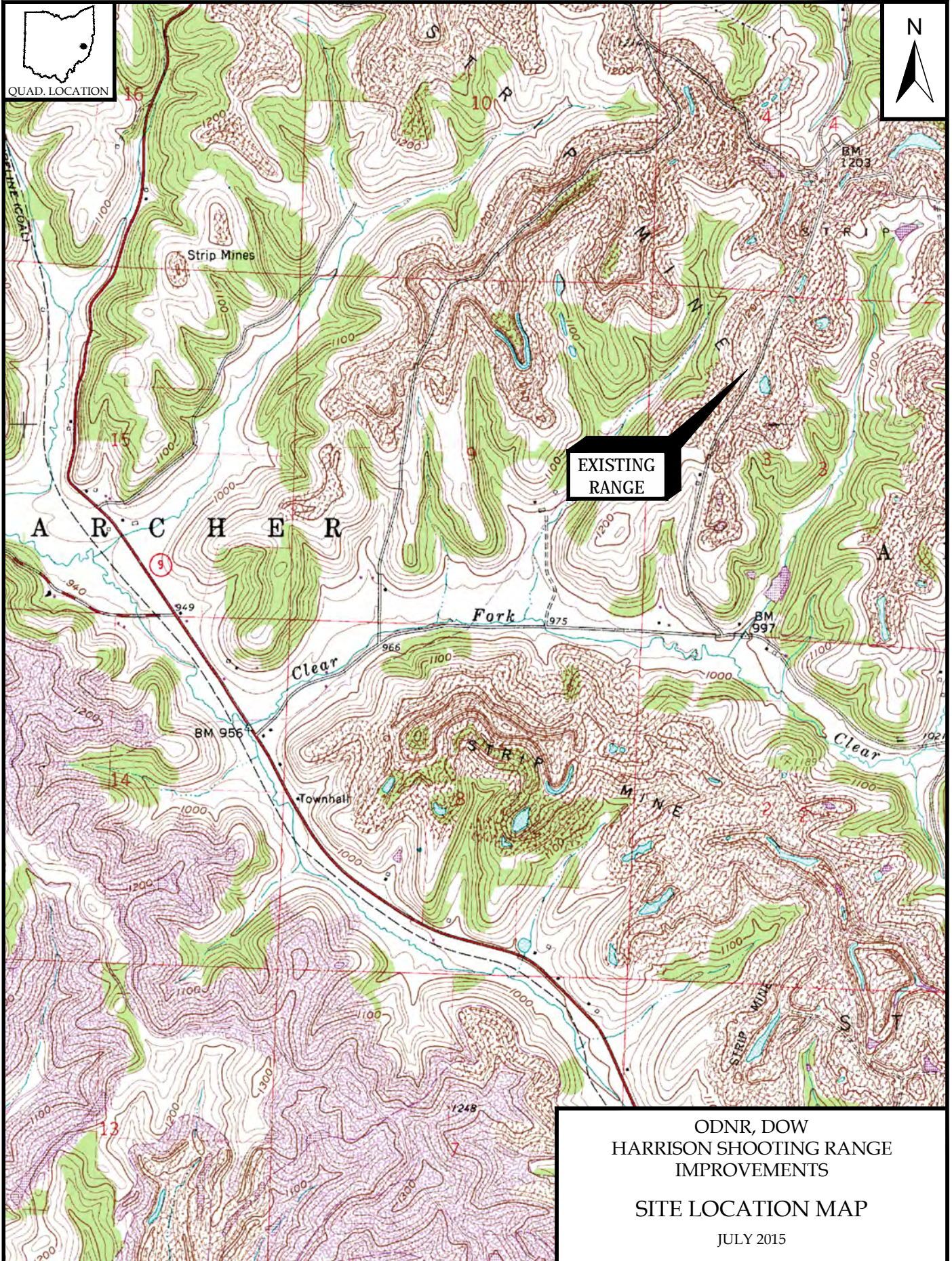

EXISTING RANGE

ODNR, DOW
HARRISON SHOOTING RANGE
IMPROVEMENTS

SITE LOCATION MAP

JULY 2015

SOURCE:
7.5 MINUTE JEWETT AND CADIZ, OH. U.S.G.S. QUADRANGLE MAP

BURGESS & NIPLE
Engineers • Environmental Scientists • Geologists

P:\PR52412\Harrison Range\Cadd\Range Location Map.dwg 7/8/2015 2:47:54 PM VanZandt, Ryan

ATTACHMENT 2
PERTINENT PLAN SHEETS

HARRISON STATE FOREST SHOOTING RANGE ASSESSMENT

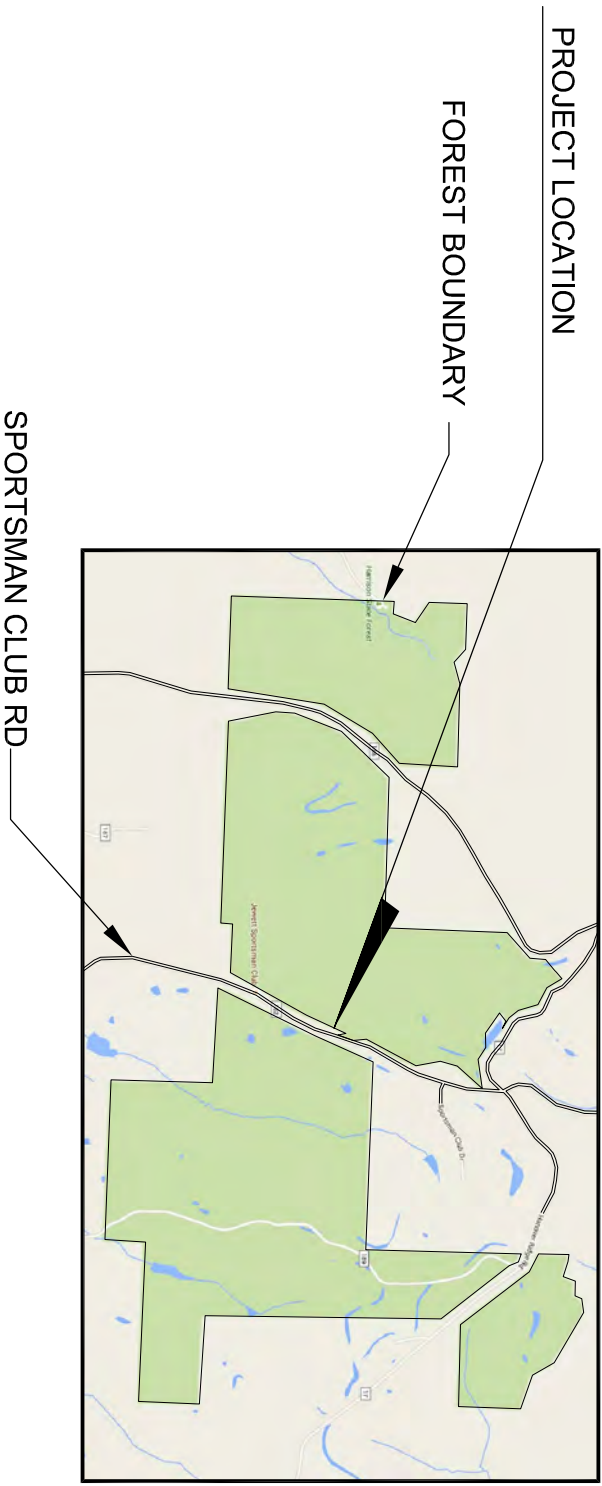

100% SCHEMATICS

PREPARED FOR

HARRISON STATE FOREST
FERNWOOD STATE FOREST
11TWP RD. 181
BLOOMINGDALE, OHIO
PH: (740)-266-6021

PREPARED THRU

BURGESS & NIPLE, INC
5085 REED ROAD
COLUMBUS, OH 43220
PH: (614) 459-2050

PREPARED BY:

C.VARGAS & ASSOCIATES, LTD.
CONSULTING ENGINEERS
8808 ARLINGTON EXPRESSWAY
JACKSONVILLE, FLORIDA 32211
PHONE: (904) 722-2294
E-MAIL: cvargas@cvaltd.com
CERT. OF AUTH. NO. 00002778

V
C. VARGAS & ASSOCIATES, LTD.
CONSULTING ENGINEERS
8808 ARLINGTON EXPRESSWAY
JACKSONVILLE, FLORIDA 32211
PHONE: (904) 722-2294 FAX: (904) 722-2297
CERT. OF AUTH. NO.00002778



ENGINEERING
Ohio Department of Natural Resources

HARRISON STATE FOREST SHOOTING
RANGE ASSESSMENT

DESIGNED BY:	
DRAWN BY:	
CHECKED BY:	
APPROVED BY:	

JOB NUMBER:	
SCALE:	
DATE:	
REVISED:	

COVER SHEET

G-1

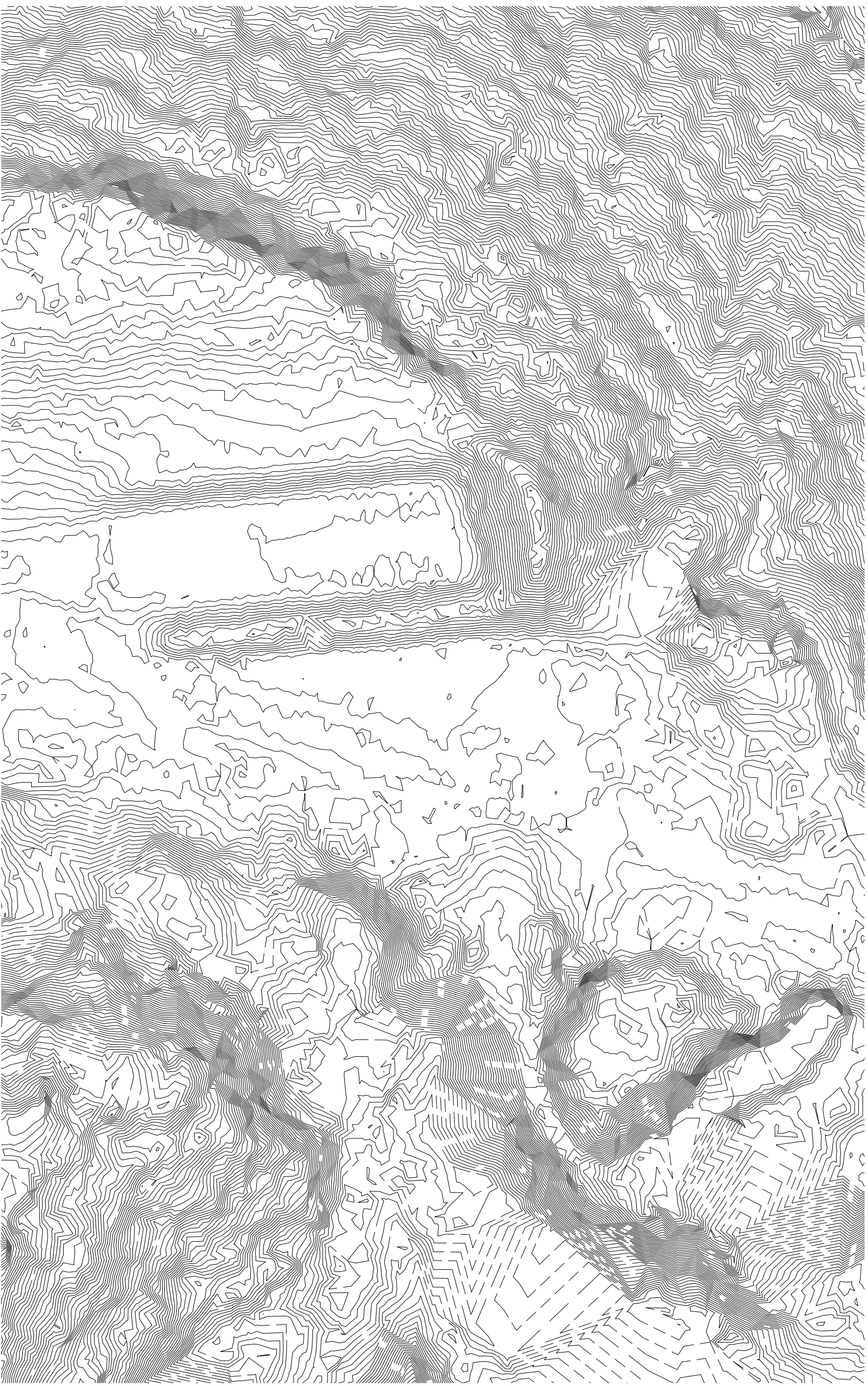

TOPOGRAPHIC SURVEY

SCALE: 1" = 50'

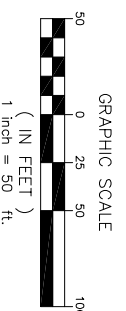
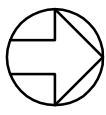

C. VARGAS & ASSOCIATES, LTD.
 SURVEYING & ENGINEERING
 8000 ANSELMO DRIVE
 CANTON, OHIO 44705
 PHONE: 330.222.2224 FAX: 330.222.2293
 CERT. OF A.S.T.M. NO.00020778



ENGINEERING
 Ohio Department of Natural Resources

HARRISON STATE FOREST SHOOTING
 RANGE ASSESSMENT

DESIGNED BY:
 DRAWN BY:
 CHECKED BY: C. VARGAS
 APPROVED BY: C. VARGAS

JOB NUMBER: -
 SCALE: NOTED
 DATE: JULY 2015
 REVISED:

TOPOGRAPHIC SURVEY

G-3

100% SCHEMATICS



MASTER SITE PLAN

SCALE: 1" = 30'

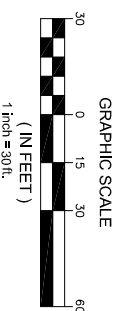

C. VARGAS & ASSOCIATES, LTD.
 SURVEYING & ENGINEERING
 8008 ARLINGTON EXPRESSWAY
 SUITE 200
 COLUMBIANA, OHIO 43085
 PHONE: 614-222-2254 FAX: 614-222-2297
 CERT. OF A.C.E. NO. 0002778



ENGINEERING
 Ohio Department of Natural Resources

HARRISON STATE FOREST SHOOTING RANGE ASSESSMENT

DESIGNED BY:
 DRAWN BY:
 CHECKED BY: C. VARGAS
 APPROVED BY: C. VARGAS

JOB NUMBER: -
 SCALE: NOTED
 DATE: JULY 2015
 REVISED:

MASTER SITE PLAN

G-4

100% SCHEMATICS

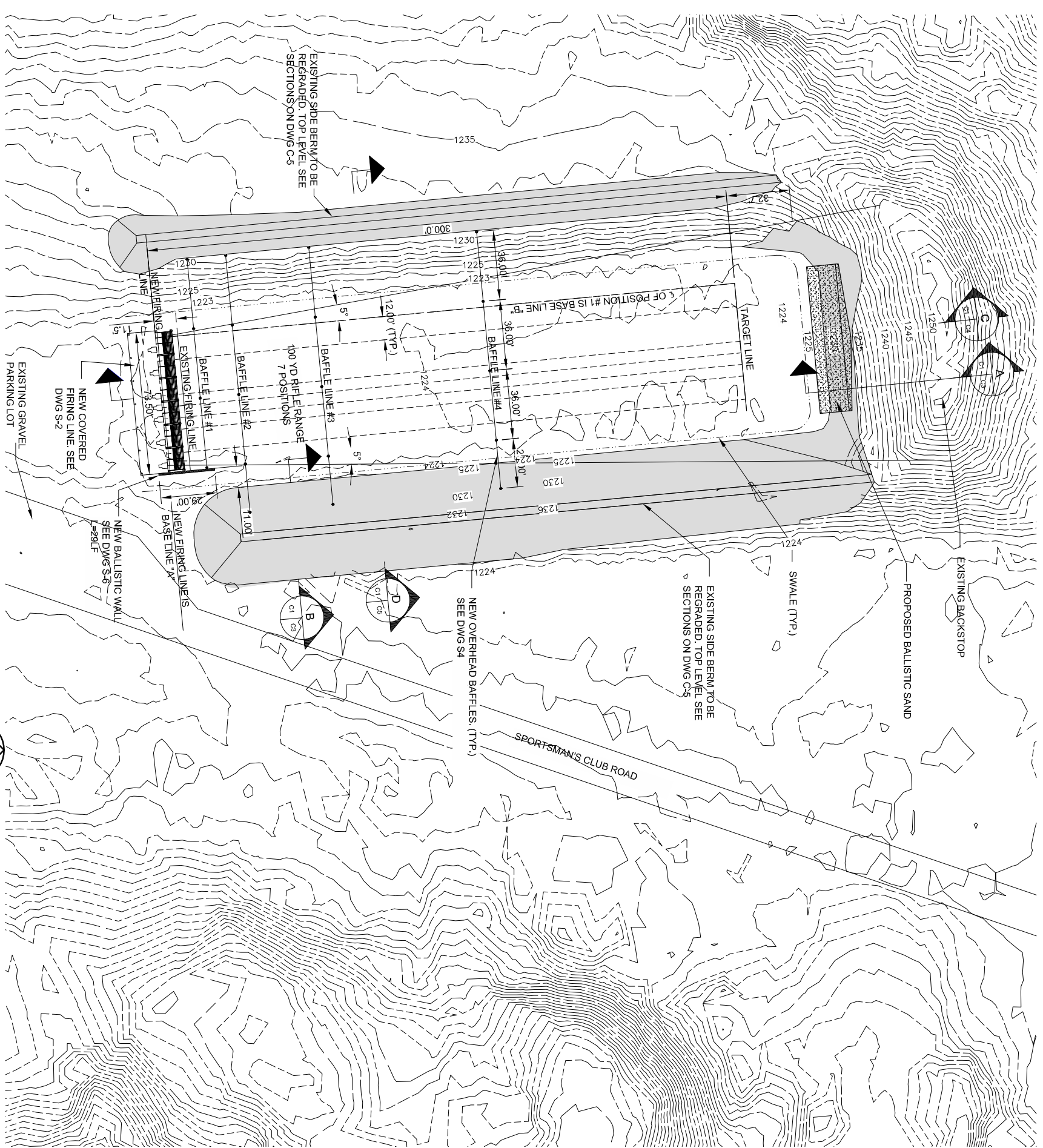

LOCATION SITE PLAN

SCALE: 1" = 30'

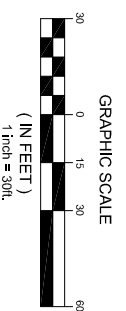
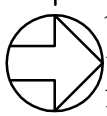

C. VARGAS & ASSOCIATES, LTD.
SURVEYING & ENGINEERING
8000 ANSELMO DRIVE
CANTON, OHIO 44705
PHONE: 330.222.2222 FAX: 330.222.2297
CERT. OF ACHT. NO.00002778



ENGINEERING
Ohio Department of Natural Resources

HARRISON STATE FOREST SHOOTING
RANGE ASSESSMENT

DESIGNED BY:
DRAWN BY:
CHECKED BY:
APPROVED BY:

JOB NUMBER: -
SCALE: NOTED
DATE: JULY 2015
REVISED:

LOCATION SITE PLAN

C1

100% SCHEMATICS

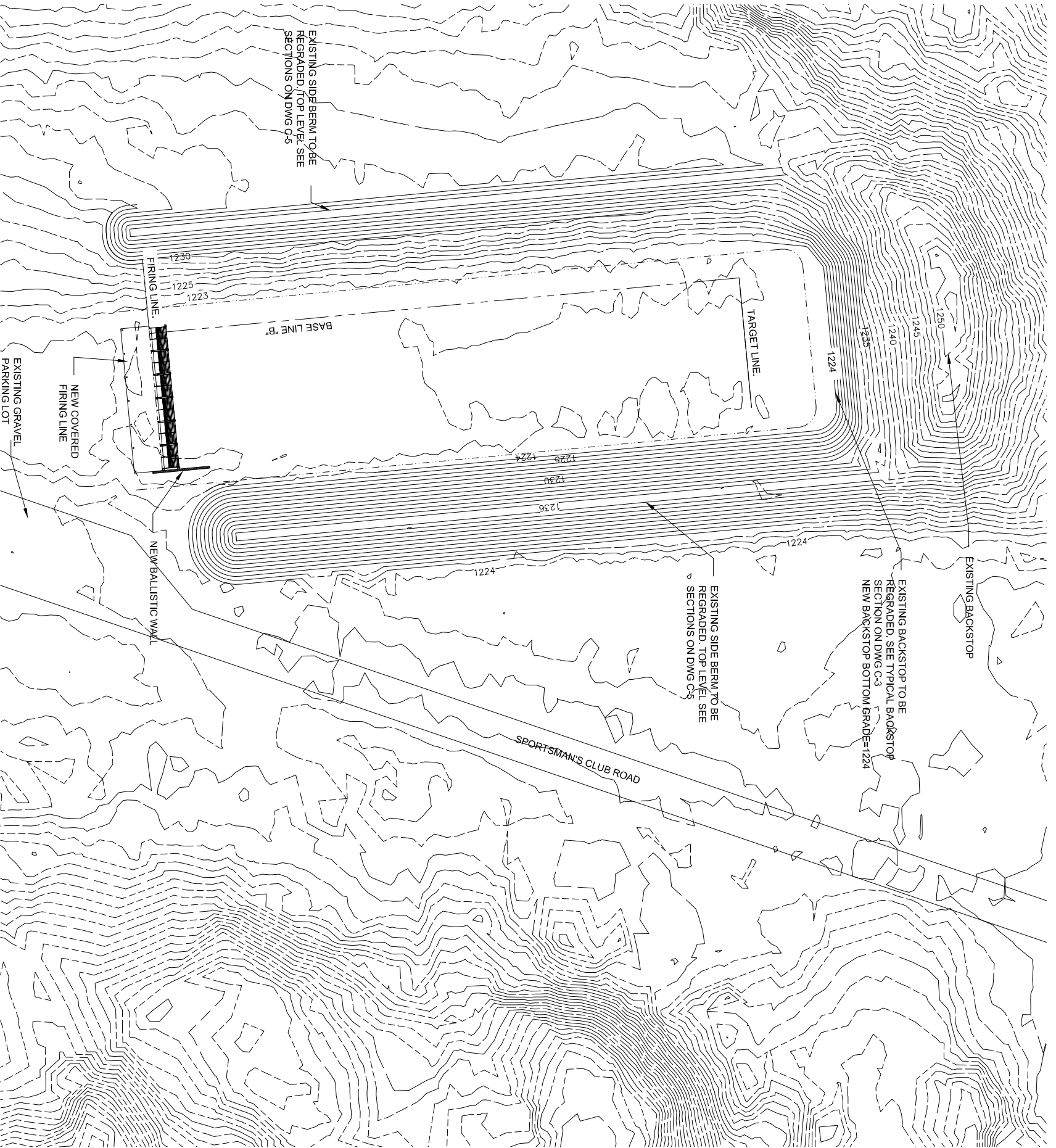

GRADING SITE PLAN

SCALE: 1" = 30'

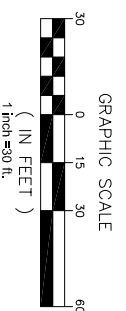
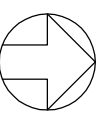

V
C. VARGAS & ASSOCIATES, LTD.
SURVEYING ENGINEERS
8008 ARLINGTON EXPRESSWAY
PHOENIX, ARIZONA 85028
PHONE: 602-222-2254 FAX: 602-222-2297
CERT. OF AUTH. NO. 00020778



ENGINEERING
Ohio Department of Natural Resources

HARRISON STATE FOREST SHOOTING
RANGE ASSESSMENT

DESIGNED BY:
DRAWN BY:
CHECKED BY:
APPROVED BY:

JOB NUMBER: -
SCALE: NOTED
DATE: JULY 2015
REVISED:

GRADING SITE PLAN

C-2

100% SCHEMATICS

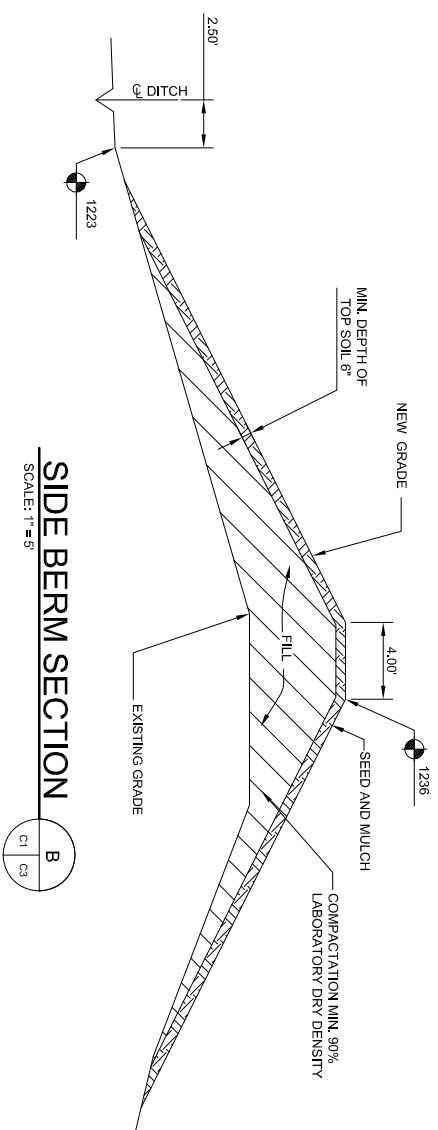

SIDE BERM SECTION B
SCALE: 1"=5'



BALLISTIC SAND

1. BALLISTIC SAND SHALL CONSIST OF THE BORROW GENERATED BY THE ACCESS CUTS SCREENED IN-SITU WITH 4" SCREEN SAND MATERIAL WITH LOAM AND/OR A CLAY MIX ADDED TO HOLD THE 3:2 SLOPES AS SHOWN. PROVIDE SOILS LABORATORY STABILITY ANALYSIS TO DEMONSTRATE MATERIAL NATURAL ANGLE OF REPOSE.
2. THE 10' HIGH BUMP OUT SHALL BE 3'-0" AS SHOWN

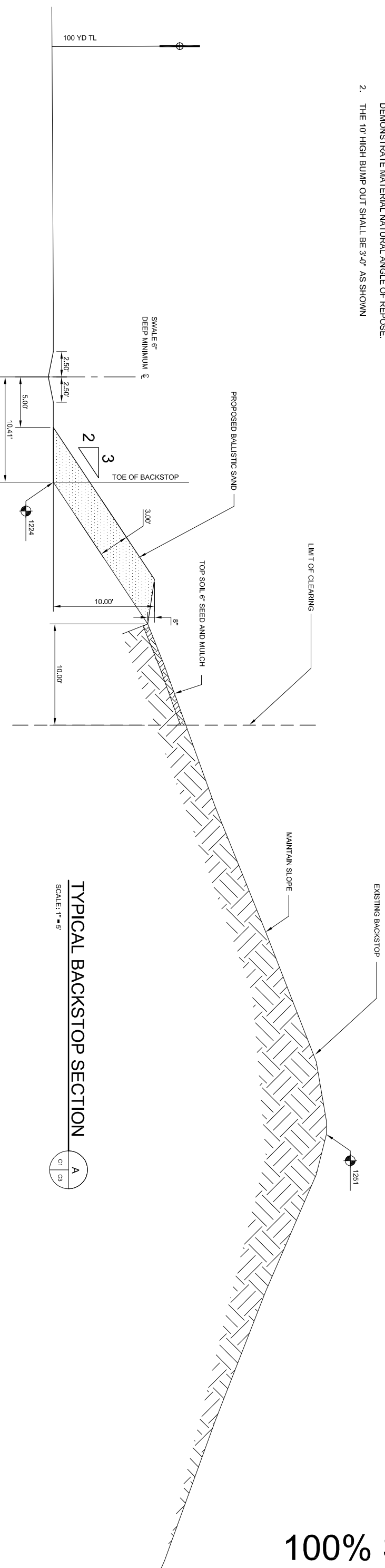

TYPICAL BACKSTOP SECTION A
SCALE: 1"=5'



DESIGNED BY:	SCALE:	JOB NUMBER:
DRAWN BY:	NOTED	
CHECKED BY: C. VARGAS	DATE: JULY 2015	
APPROVED BY: C. VARGAS	REVISED:	

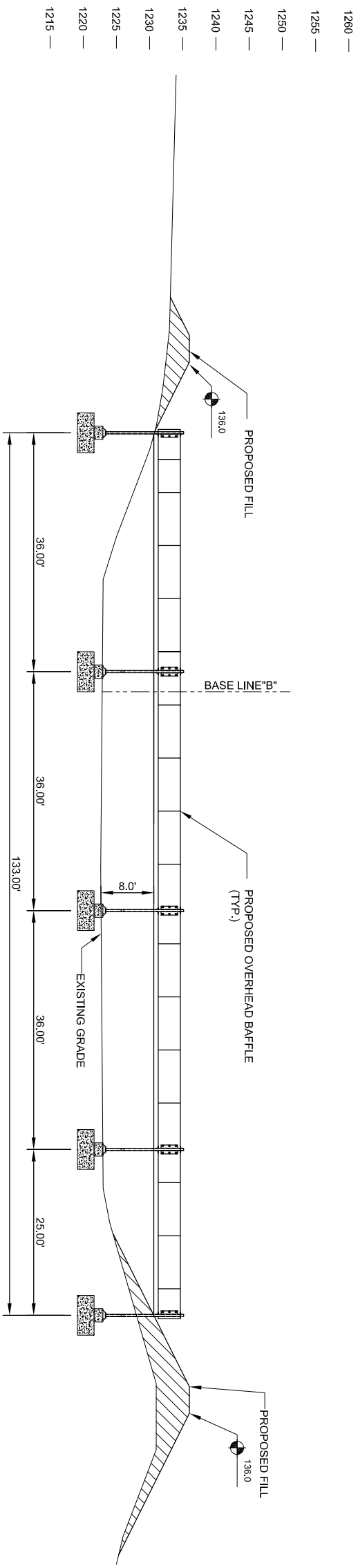

TRANSVERSE SECTION
SCALE: 1" = 10'

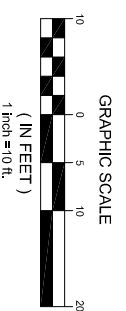

100% SCHEMATICS



DESIGNED BY:	JOB NUMBER: -
DRAWN BY:	SCALE: NOTED
CHECKED BY:	DATE: JULY 2015
APPROVED BY:	REVISED:

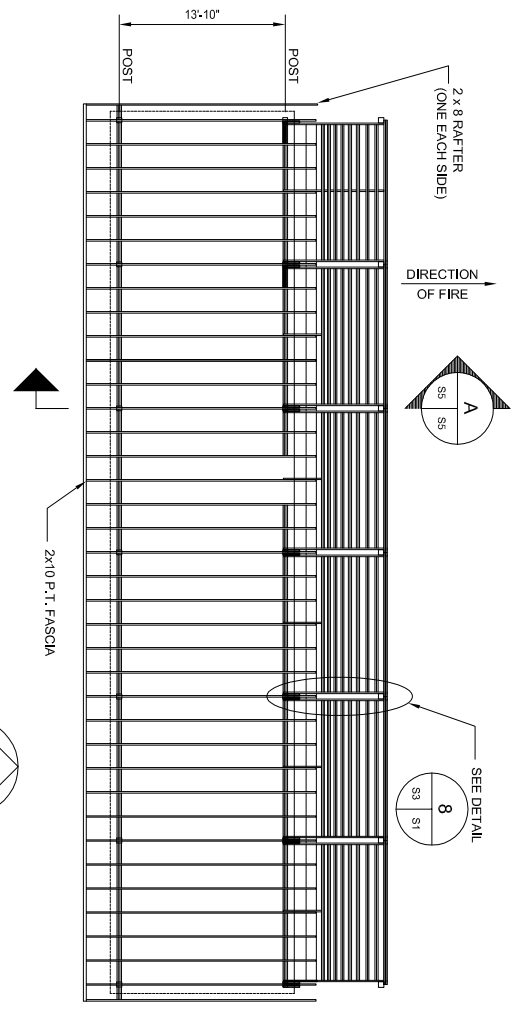

ROOF FRAMING PLAN
 SCALE: 1/8" = 1'-0"

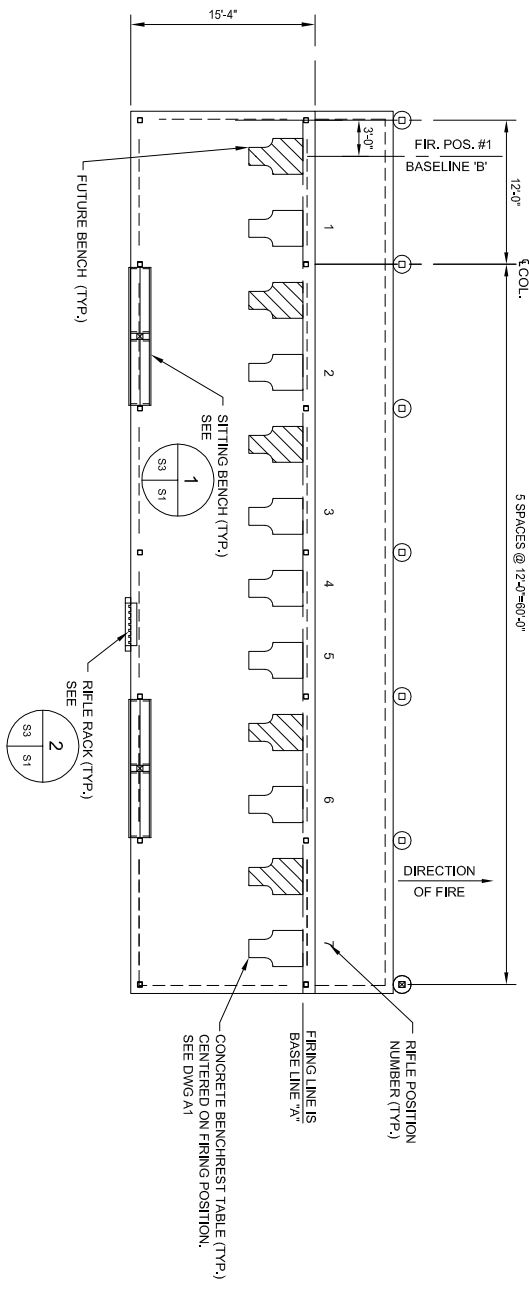

FLOOR PLAN
 SCALE: 1/8" = 1'-0"

- POST LEGEND**
- ROOF SUPPORT STEEL COL. (TS&K(1/4))
 - ▣ 6x6 P.T. WOOD POST
 - ⊠ SHORT POST FOR SHOOTING OR SITTING BENCH

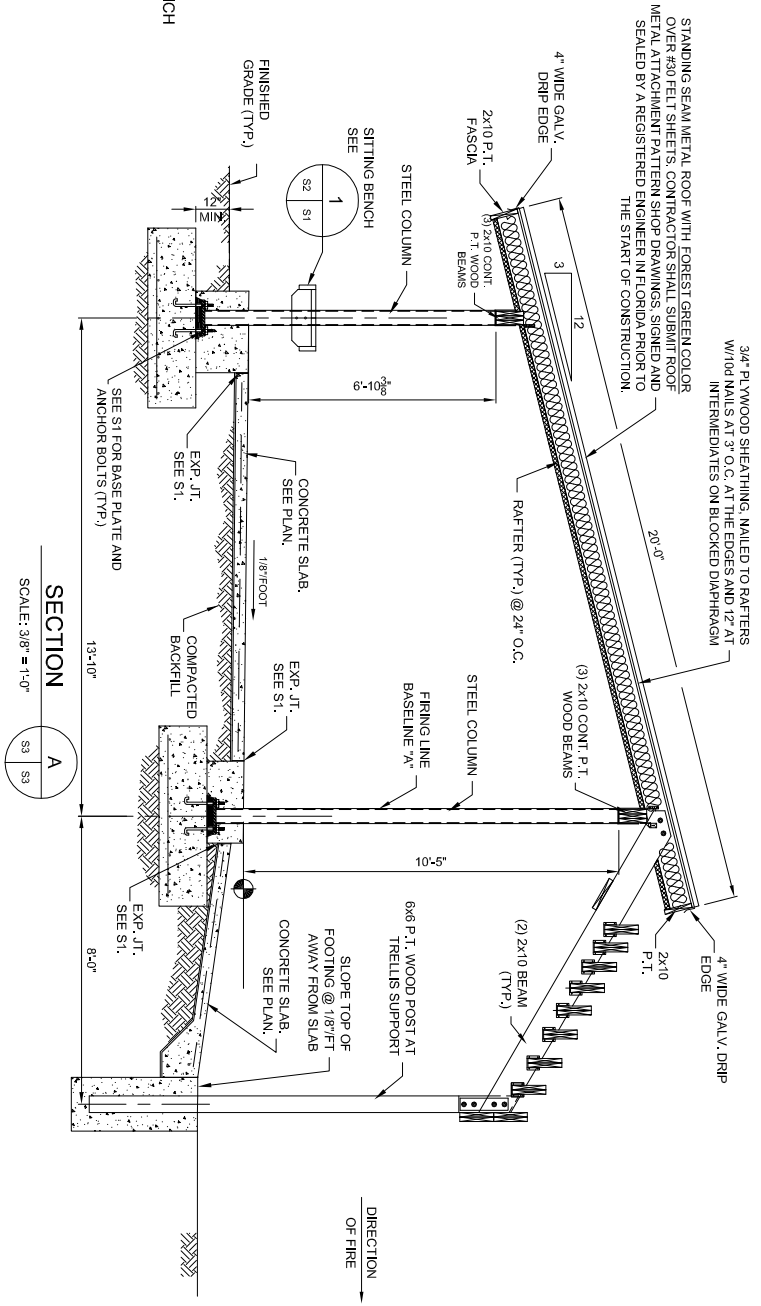

SECTION A
 SCALE: 3/8" = 1'-0"



GRAPHIC SCALE
 SCALE: 1/8" = 1'

ATTACHMENT 3
SUPPORTING SITE MAPS
(NWI & FEMA)



U.S. Fish and Wildlife Service National Wetlands Inventory

Harrison State
Forest Range

Feb 18, 2015



Wetlands

- Freshwater Emergent
- Freshwater Forested/Shrub
- Estuarine and Marine Deepwater
- Estuarine and Marine
- Freshwater Pond
- Lake
- Riverine
- Other

This map is for general reference only. The US Fish and Wildlife Service is not responsible for the accuracy or currentness of the base data shown on this map. All wetlands related data should be used in accordance with the layer metadata found on the Wetlands Mapper web site.

User Remarks:

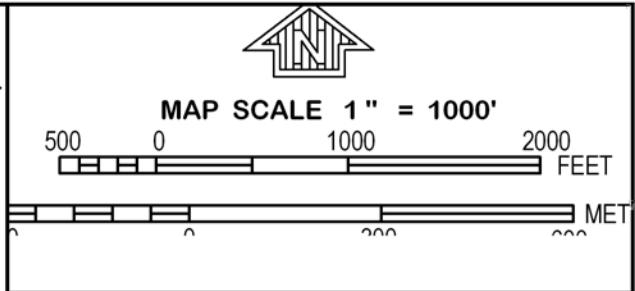

NATIONAL FLOOD INSURANCE PROGRAM
 FIP

PANEL 0185D

FIRM
 FLOOD INSURANCE RATE MAP
 HARRISON COUNTY,
 OHIO
 AND INCORPORATED AREAS

PANEL 185 OF 375
 (SEE MAP INDEX FOR FIRM PANEL LAYOUT)

CONTAINS:

COMMUNITY	NUMBER	PANEL	SUFFIX
HARRISON COUNTY	390255	0185	D

Notice to User: The Map Number shown below should be used when placing map orders; the Community Number shown above should be used on insurance applications for the subject community.



MAP NUMBER
 39067C0185D
EFFECTIVE DATE
 MAY 4, 2009

Federal Emergency Management Agency

This is an official copy of a portion of the above referenced flood map. It was extracted using F-MIT On-Line. This map does not reflect changes or amendments which may have been made subsequent to the date on the title block. For the latest product information about National Flood Insurance Program flood maps check the FEMA Flood Map Store at www.msc.fema.gov

ATTACHMENT 4
SECTION 106 CORRESPONDENCE



In replies, please refer to
2015-HAS-32564

September 28, 2015

Jennifer Walker
Burgess & Niple, Inc.
5085 Reed Rd.
Columbus, OH 43220

Dear Ms. Walker:

Re: Proposed Shooting Range Improvements at Harrison State Forrest, Harrison County, Archer Township, Ohio.

This letter is in response to your correspondence (received on August 27, 2015) regarding the Proposed Shooting Range Improvements at Harrison State Forrest. My comments are in accordance to Section 106 of the National Historic Preservation Act of 1966, as amended, and the associated regulations at 36 CFR Part 800.

The project involves making improvements to an existing shooting range at the Harrison State Forest. The improvements will include: construction of a new covered firing line, regrading existing berms and backstop, the installation of a drainage swale, and the construction of an overhead baffle.

Based on the information submitted, it is my opinion that the proposed undertaking will have no effect on properties listed or eligible for listing on the National Register of Historic Places. No further coordination is necessary unless the project changes or archaeological remains are discovered during the course of the project. In such a situation, this office should be contacted as per 36 CFR 800.13. Thank you for your cooperation.

If you have any questions, please contact me at (614) 298-2000, or via email at jbelleville@marrion@ohiohistory.org.

Sincerely,

A handwritten signature in black ink, appearing to read "Jennifer Bellville-Marrion", followed by a horizontal line.

Jennifer Bellville-Marrion, Project Reviews Coordinator
Resource Protection and Review

ATTACHMENT 5
T&E CORRESPONDENCE
(USFWS & ODNR)

Walker, Jennifer

From: susan_zimmermann@fws.gov on behalf of Ohio, FW3 <ohio@fws.gov>
Sent: Monday, September 21, 2015 2:51 PM
To: Walker, Jennifer
Subject: Shooting Range Improvements in Harrison State Forest near Cadiz, Harrison Co. OH



UNITED STATES DEPARTMENT OF THE INTERIOR
U.S. Fish and Wildlife Service
Ecological Services Office
4625 Morse Road, Suite 104
Columbus, Ohio 43230
(614) 416-8993 / Fax (614) 416-8994



TAILS# 03E15000-2015-TA-1606

Dear Ms. Walker,

We have received your recent correspondence requesting information about the subject proposal. There are no federal wilderness areas, wildlife refuges or designated critical habitat within the vicinity of the project area. The following comments and recommendations will assist you in fulfilling the requirements for consultation under section 7 of the Endangered Species Act of 1973, as amended (ESA).

The U.S. Fish and Wildlife Service (Service) recommends that proposed developments avoid and minimize water quality impacts and impacts to high quality fish and wildlife habitat (e.g., forests, streams, wetlands). Additionally, natural buffers around streams and wetlands should be preserved to enhance beneficial functions. If streams or wetlands will be impacted, the Corps of Engineers should be contacted to determine whether a Clean Water Act section 404 permit is required. Best management practices should be used to minimize erosion, especially on slopes. All disturbed areas should be mulched and revegetated with native plant species. Prevention of non-native, invasive plant establishment is critical in maintaining high quality habitats.

FEDERALLY LISTED SPECIES COMMENTS: All projects in the State of Ohio lie within the range of the federally endangered **Indiana bat** (*Myotis sodalis*) and the federally threatened **northern long-eared bat** (*Myotis septentrionalis*). In Ohio, presence of the Indiana bat and northern long-eared bat is assumed wherever suitable habitat occurs unless a presence/absence survey has been performed to document absence. Suitable summer habitat for Indiana bats and northern long-eared bats consists of a wide variety of forested/wooded habitats where they roost, forage, and travel and may also include some adjacent and interspersed non-forested habitats such as emergent wetlands and adjacent edges of agricultural fields, old fields and pastures. This includes forests and woodlots containing potential roosts (i.e., live trees and/or snags ≥ 3 inches diameter at breast height (dbh)

that have any exfoliating bark, cracks, crevices, hollows and/or cavities), as well as linear features such as fencerows, riparian forests, and other wooded corridors. These wooded areas may be dense or loose aggregates of trees with variable amounts of canopy closure. Individual trees may be considered suitable habitat when they exhibit the characteristics of a potential roost tree and are located within 1,000 feet (305 meters) of other forested/wooded habitat. Northern long-eared bats have also been observed roosting in human-made structures, such as buildings, barns, bridges, and bat houses; therefore, these structures should also be considered potential summer habitat. In the winter, Indiana bats and northern long-eared bats hibernate in caves and abandoned mines.

The proposed project is in the vicinity of one or more confirmed records of northern long-eared bats. Therefore, we recommend that trees ≥ 3 inches dbh be saved wherever possible. Because the project will result in a small amount of forest clearing relative to the available habitat in the immediately surrounding area, habitat removal is unlikely to result in significant impacts to Indiana bats or northern long-eared bats. Since northern long-eared bat presence in the vicinity of the project has been confirmed and presence of Indiana bats is assumed, clearing of trees during the summer roosting season may result in direct take of individuals. If any caves or abandoned mines may be disturbed, further coordination with this office is requested to determine if fall or spring portal surveys are warranted. If no caves or abandoned mines are present and tree removal is unavoidable, we recommend that removal of any trees ≥ 3 inches dbh only occur between October 1 and March 31. Following this seasonal tree clearing recommendation should ensure that any effects to Indiana bats and northern long-eared bats are insignificant or discountable. **Please note that, because northern long-eared bat presence has already been confirmed in the project vicinity, any additional summer surveys would not constitute presence/absence surveys for northern long-eared bats.**

If there is a federal nexus for the project (e.g., federal funding provided, federal permits required to construct), no tree clearing should occur on any portion of the project area until consultation under section 7 of the ESA, between the Service and the federal action agency, is completed. We recommend that the federal action agency submit a determination of effects to this office, relative to the Indiana bat and northern long-eared bat, for our review and concurrence.

Due to the project type, size, and location, we do not anticipate adverse effects to any other federally endangered, threatened, proposed, or candidate species. Should the project design change, or during the term of this action, additional information on listed or proposed species or their critical habitat become available, or if new information reveals effects of the action that were not previously considered, consultation with the Service should be initiated to assess any potential impacts.

These comments have been prepared under the authority of the Fish and Wildlife Coordination Act (48 Stat. 401, as amended; 16 U.S.C. 661 et seq.), the ESA, and are consistent with the intent of the National Environmental Policy Act of 1969 and the Service's Mitigation Policy. This letter provides technical assistance only and does not serve as a completed section 7 consultation document. We

recommend that the project be coordinated with the Ohio Department of Natural Resources due to the potential for the project to affect state listed species and/or state lands. Contact John Kessler, Environmental Services Administrator, at (614) 265-6621 or at john.kessler@dnr.state.oh.us.

If you have questions, or if we can be of further assistance in this matter, please contact our office at (614) 416-8993 or ohio@fws.gov.

Sincerely,

A handwritten signature in blue ink that reads "Dan Everson". The signature is fluid and cursive, with the first name "Dan" being more prominent than the last name "Everson".

Dan Everson
Field Office Supervisor



Ohio Department of Natural Resources

JOHN R. KASICH, GOVERNOR

JAMES ZEHRINGER, DIRECTOR

Ohio Division of Wildlife

Scott Zody, Chief
2045 Morse Rd., Bldg. G
Columbus, OH 43229-6693
Phone: (614) 265-6300

July 9, 2015

Jennifer Walker
Burgess & Niple, Inc.
5085 Reed Rd.
Columbus, OH 43220

Dear Ms. Walker,

After reviewing the Natural Heritage Database, I find the Division of Wildlife has no records of rare or endangered species in the Harrison State Forest Shooting Range Improvements project area, including a one mile radius, in Archer Township, Harrison County, Ohio. Outside of this project site being located within a State Forest (ODNR Division of Forestry), we are unaware of any unique ecological sites, geologic features, animal assemblages, scenic rivers, state wildlife areas, nature preserves or parks, national wildlife refuges, parks or forests or other protected natural areas within a one mile radius of the project area. We also have no records for Indiana Bat (*Myotis sodalis*) capture locations within a five mile radius or hibernacula within a ten mile radius of the project site. The nearest Bald Eagle nest is approximately six miles to the west of the project area. Bald Eagle nest locations are based on survey data that was last collected in 2012. Since the Bald Eagle was removed from the state rare species list, the Natural Heritage Program will no longer be maintaining comprehensive Bald Eagle nest data going forward.

Our inventory program has not completely surveyed Ohio and relies on information supplied by many individuals and organizations. Therefore, a lack of records for any particular area is not a statement that rare species or unique features are absent from that area. This letter only represents a review of rare species and natural features data within the Ohio Natural Heritage Database. It does not fulfill coordination under the National Environmental Policy Act (NEPA) or the Fish and Wildlife Coordination Act (48 Stat. 401, as amended; 16 U.S. C. 661 et seq.) and does not supersede or replace the regulatory authority of any local, state or federal agency nor relieve the applicant of the obligation to comply with any local, state or federal laws or regulations.

Please contact me at 614-265-6818 if I can be of further assistance.

Sincerely,

A handwritten signature in blue ink that reads "Debbie Woischke".

Debbie Woischke
Ohio Natural Heritage Database Program

ATTACHMENT 6
PHOTOGRAPHS & PHOTO KEY



MASTER SITE PLAN

SCALE: 1" = 30'

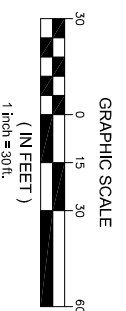

C. VARGAS & ASSOCIATES, LTD.
 SURVEYING & ENGINEERING
 8008 ARLINGTON EXPRESSWAY
 SUITE 200
 COLUMBUS, OHIO 43228-1234
 PHONE: 614-222-2254 FAX: 614-222-2297
 CERT. OF A.C.E. NO. 00002778



ENGINEERING
 Ohio Department of Natural Resources

HARRISON STATE FOREST SHOOTING RANGE ASSESSMENT

DESIGNED BY:
 DRAWN BY:
 CHECKED BY: C. VARGAS
 APPROVED BY: C. VARGAS

JOB NUMBER: -
 SCALE: NOTED
 DATE: JULY 2015
 REVISED:

MASTER SITE PLAN

G-4

100% SCHEMATICS

Proposed Shooting Range Improvements
Harrison State Forest



Photograph 1 Existing gravel parking lot located along Township Road (TR) 182, east edge of shooting range. Photo is looking south with range to right and TR 182 to left.



Photograph 2 Overview of range looking north from edge of parking lot.

July 1, 2015

Proposed Shooting Range Improvements
Harrison State Forest



Photograph 3 Looking north at berm along west edge of range.



Photograph 4 Existing backstop at range.

July 1, 2015

Proposed Shooting Range Improvements
Harrison State Forest



Photograph 5 Overview of range looking south from backstop at shooting benches.



Photograph 6 View of berm along east edge of range looking southeast.

July 1, 2015

Proposed Shooting Range Improvements
Harrison State Forest



Photograph 7 Another view of berm that separates range from TR 182. Photo is looking north from edge of parking lot.

July 1, 2015